

Gnome Gnome



Materials Needed:

- ✓ Red or green paper
- ✓ Black construction paper
- ✓ White construction paper
- ✓ Marker
- ✓ Scissors
- ✓ Glue

Steps:

1. Fold paper in half leaving a small tab to fold over. Fold the tab and glue it so that it is secured.



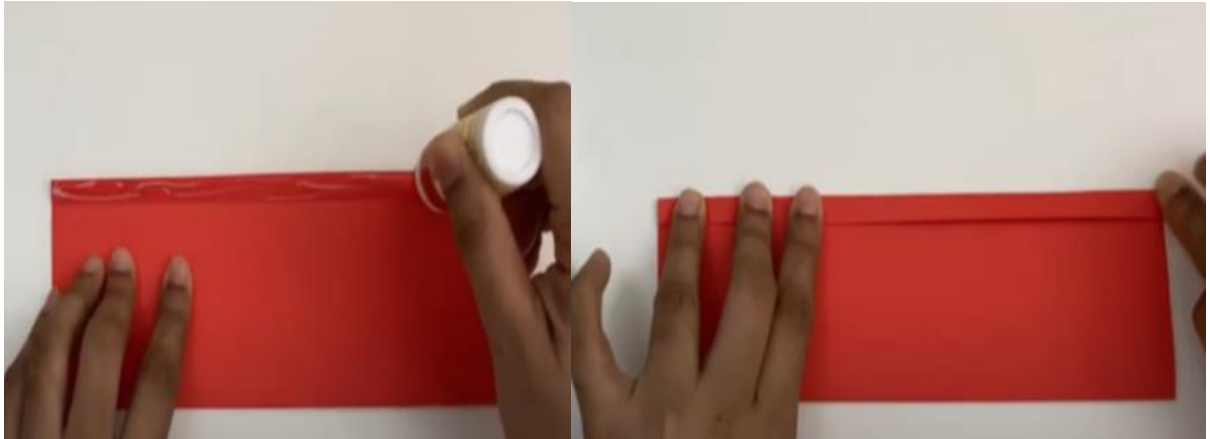

2. Fold that in half and open it back up.



3. Take a white piece of paper and fold it in half. Cut a curve with 2 points to make the beard. Open it up.

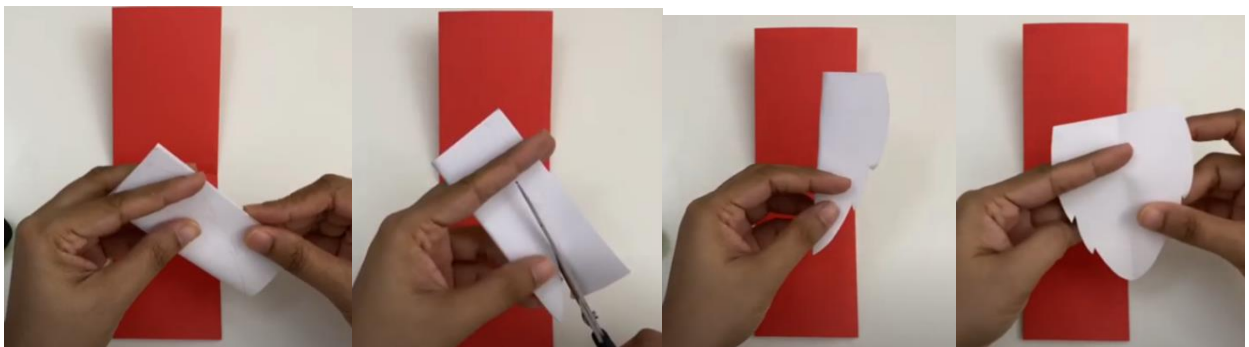

4. Glue it on the inside the red paper.



5. Fold the black construction paper and cut a "L" shape out for the boots. Open it up and cut the boots in half to be individuals. Glue them on the red paper underneath the beard.

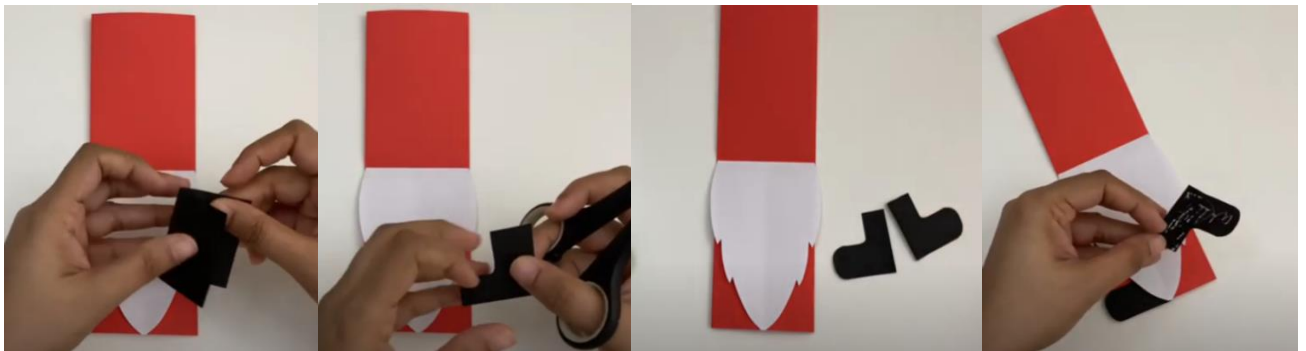

6. Fold the top part of the red flap diagonally. Then fold the other side. Glue it down so it is secure.



The Shafer Center
CREATING OPPORTUNITIES FOR SUCCESS

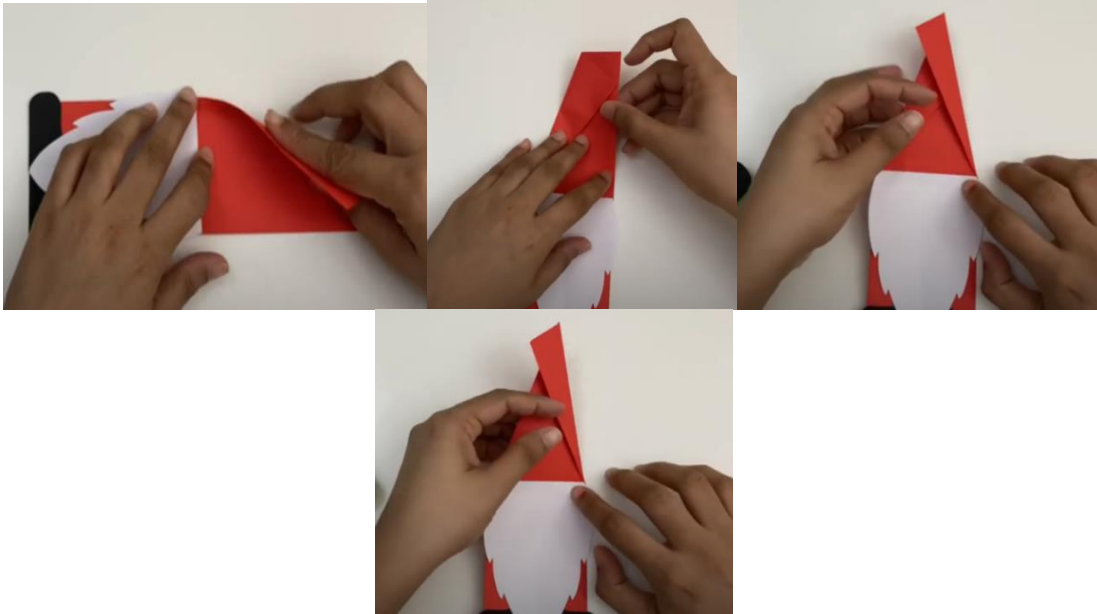

7. Cut out a beige circle and paste it at the top of the beard for the nose.



8. Glue two eyeballs on above the nose.



9. Cut out a circle from the white piece of paper. Paste it at the top of the hat.



10. Draw a small mouth with a sharpie or black pen.



Additional Skill Practice:

Here are some additional skills you can work on with your kiddo related to this craft:

- Color Identification – What is the color of the gnome?
- Shape Identification – What is the shape of the gnome's hat?
- Pretend Play – take your gnome outside on an adventure